

### Model No.: GP23AE

**Description** : Alkaline High Voltage Battery

**Nominal Voltage** : 12Volts

**Nominal Dimensions** : Ø10.22mmx28.5mm

**Terminal** : Nickel plated flat contacts - protruded red(+); recessed black (-)

**Jacket** : Metal jacket

**Internal Connection** : Pressure

**Applications** : Remote controller

**Average Weight** : 7.9g

**Date Code** : Unless otherwise specified, each batteries will carry a numeric year code and analogue month code

**Shelf Life** : Not less than 90% of the service capacity within first year. , not less than 85% of the service capacity with third year storage at 22 ± 3 °C 40-80 %RH

**Insulation** : 5MΩ min.

**Resistance**

**Close Circuit Voltage** : 9.5 Volts (min.)(load resistor 400Ω at 22 ± 3 °C for 0.1 to 2 seconds)

**Current Drain** : Under 15mA pulse, 0.5mA continuous

**Nominal Service Life** : 107hrs (at 20kΩ load) (to 6.0V at 22 ± 3 °C)

**Average Service** : 55mAh(at 20kΩ load)

**Capacity** (to 6.0V at 22 ± 3 °C)

**Cross References:**

GP	Eveready	Duracell	Varta
23A	A23	MN21	V23GA

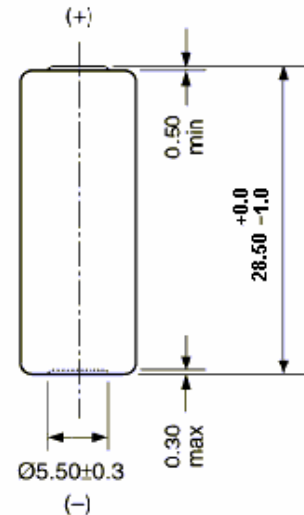
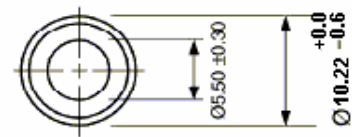

Unit : mm

### Typical Discharge characteristics at 22 ± 3 °C

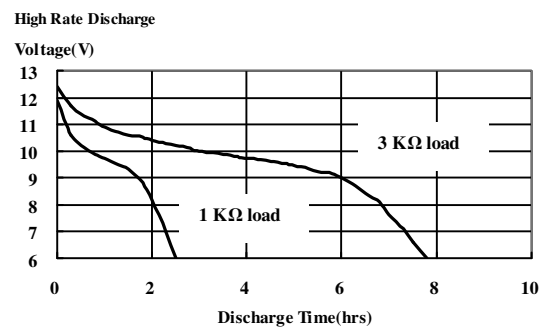
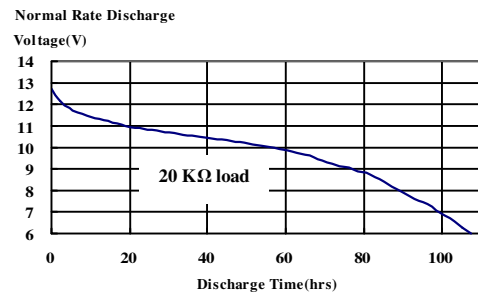

The information (subject to change without prior notice) contained in this document is for reference only and should not be used as a basis for product guarantee or warranty. For applications other than those described here, please consult your nearest GP Sales and Marketing Office or Distributors.